

Especificaciones Técnicas

Carpintería practicable
 Cámara nacional
 Doble Junta

Sección de Marco..... 40 mm
 Sección de Hoja..... 40 mm
 Galce de vidrio..... Vidrios hasta 24 mm (27 mm de hueco)

Clasificación Obtenida

Permeabilidad al aire*	CLASE 3
Estanqueidad al agua*	CLASE 6A
Resistencia al viento*	CLASE C5
<hr/>	
Transmitancia térmica** Uw	3.7 W/m² K
Aislamiento Acústico***	31 (-1;-4) dB

- * Ventana de 2 hojas de 1230 x 1480 mm
- ** Ventana de 2 hojas de 1480 x 2180 mm con cajón de persiana; vidrio 4/10/4 - UNE-EN ISO 10077-1:2010
- *** Ventana de 2 hojas de 1230 x 1480 mm; vidrio 4/10/4 - UNE-EN ISO 10140-2:2011

Posibilidades de Apertura

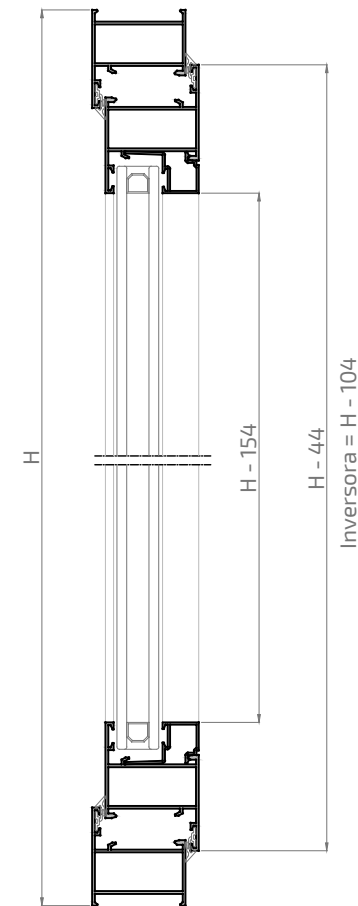
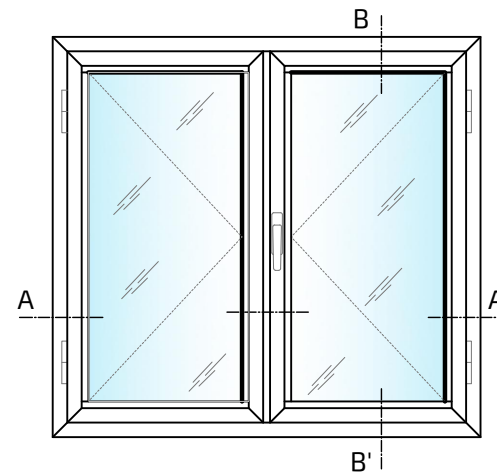
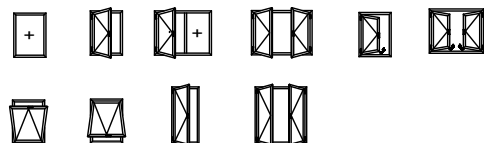

Sección B-B'

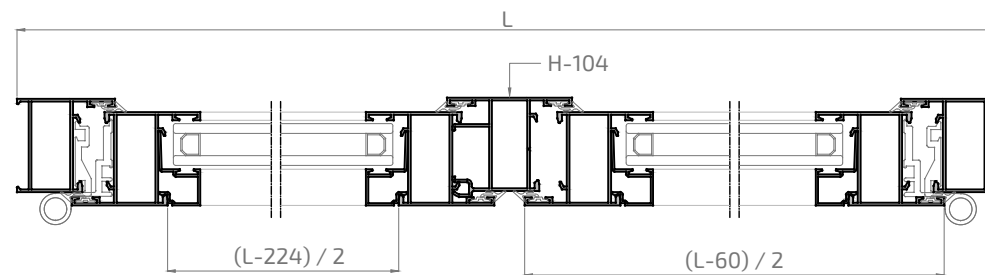

Sección A-A'

Los ensayos de las ventanas realizados por el grupo ALUGOM, que son cedidos para la obtención del marcado CE por parte del cliente, se han realizado con los perfiles y accesorios específicos y concretos propuestos por el grupo ALUGOM, que figuran en los manuales de fabricación de cada serie. Para más información consultar con la sección técnico comercial del grupo ALUGOM.

100 2541
Cercos 28 mm S-100

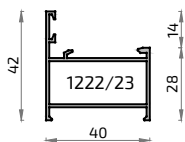

181 2595
Cercos 23 mm S-100

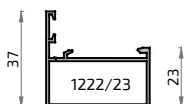

134 2542
Cercos con Solapa S-100

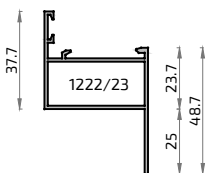

115 2548
Cercos 48 mm S-100

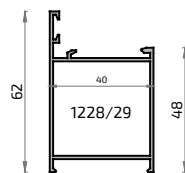

138 2534
Hoja para Lamas S-100

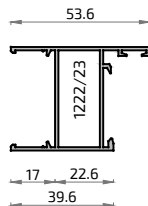

126 2526
Cercos Escaparate 43 mm S-100

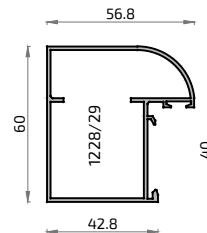

180 2591
Cercos Escaparate 48 mm S-100

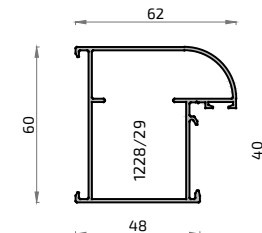

137 2533
Acople Inversora S-100

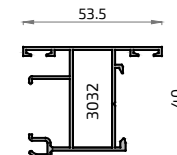

101 2544
Hoja Lisa Ventana S-100

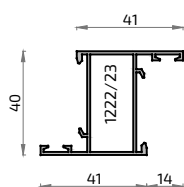

116 2550
Hoja Lisa Portada S-100

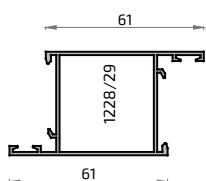

147 2594
Hoja Balconera Curva S-100

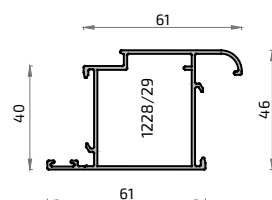

113 2546
Pilastra Lisa 27 mm S-100

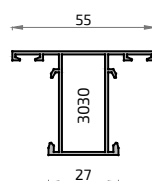

119 2552
Pilastra 47 mm S-100

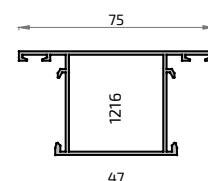

583 6653
Unión de cercos reductor

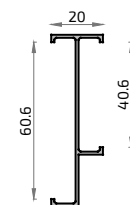

646 6144
Unión cercos 40 mm

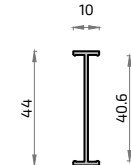

125 2523
Vierteaguis 30 mm

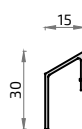

120 2508
Manguetón Central 110 mm S-100

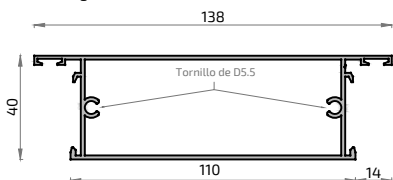

123 2507
Cercos Zócalo 111 mm S-100

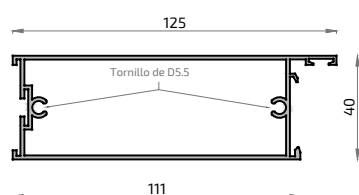

124 2522
Pletina Falleba larga

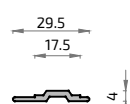

141 2578
Pletina Falleba plana

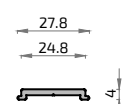

142 2579
Acople Vaivén S-100 y 350

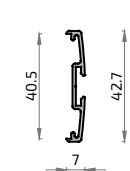

630 6102
Esquinero Redondo 40 mm

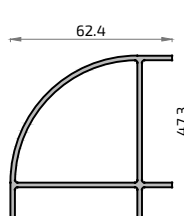

506 6612
Esquinero 60x40 mm

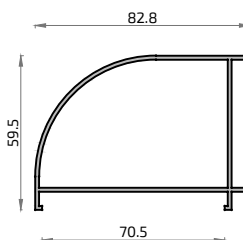

148 2593
Esquinero Regul. Tubo 40

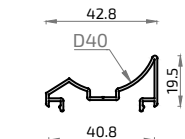

132 2532
Solapa 40 mm

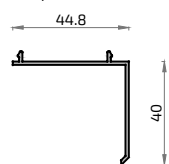

114 2575
Junquillo 27 mm

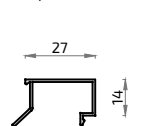

107 2559
Junquillo 22,6 mm

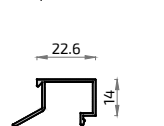

109 2577
Junquillo 19,5 mm

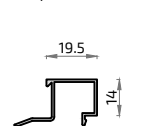

105 2519
Junquillo 16 mm

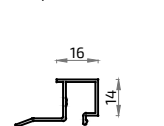

108 2560
Junquillo 15,5 mm

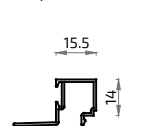



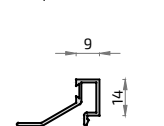





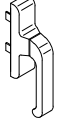
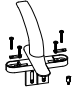
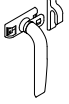



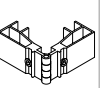

111 2520
Junquillo 9 mm

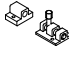
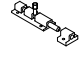

NO STOCK FUERA DE STOCK Consultar plazo y condiciones de entrega

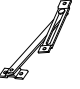
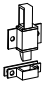
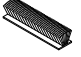
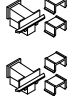
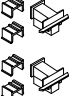
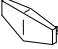
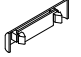
Este folleto tiene un valor meramente informativo. El Grupo ALUGOM se reserva el derecho a realizar cualquier tipo de modificación, anular, eliminar definitiva o parcialmente, o quitar de stock cualquier perfil y/o accesorio que aparece en este documento, sin previo aviso.

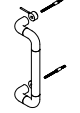
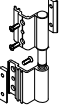
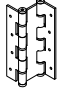
Cremonas y Manillas	1032 Cremona giro Alugom 	1033 Cremona Patilla Apertura Externa 	1044 Cierre presión (pequeño) 	Escuadras	1222 Escuadra 5-100 40x20 Centrada 	1223 Escuadra 5-100 40x20 Descentrada 	1224 Escuadra ángulo variable 	1225 Escuadra ángulo variable puerta 	1228 Escuadra 5-100 40x40 Centrada 	1229 Escuadra 5-100 40x40 Descentrada 	Tacos	1215 Tocho 5-100 40 x 20 	1216 Tocho 5-100 40 x 40 			
	Elementos de cierre	1048 Kit Cremona 5-100 	1060 Pasador plano ancho nylon 		1056 Pasador 50 mm 	1057 Pasador 100 mm 	1058 Pasador 200 mm 	1059 Pasador 300 mm 	1006 Bisagra compás 	1031 Cierre golpete 		2040 Cepillo Vaivén 14 x 12 	Tapas	3030 Tapa inversora 5-100 (113) 	3032 Tapa inversora 5-350 (137) 	4035 Embellecedor salida aguas 
		4337 Embellecedor salida aguas con membrana 	Juntas		3017 Junta 5-100 y 5-350 	Tirador	1076 Juego tirador Style 	Bisagras	1009 Bisagra deslizante c/regleta 	1007 Bisagra vaivén 						

Acc. Varios

Ver ampliado en página según índice:

- Cerraduras