

MATRIZ ABIERTA: 200 mm.
 MATRIZ CERRADA: 175 mm.
 RECORRIDO: 25 mm.
 MATRIZ 4 COLUMNAS
 MUELLES DE RECUPERACION

VISTA FRONTAL

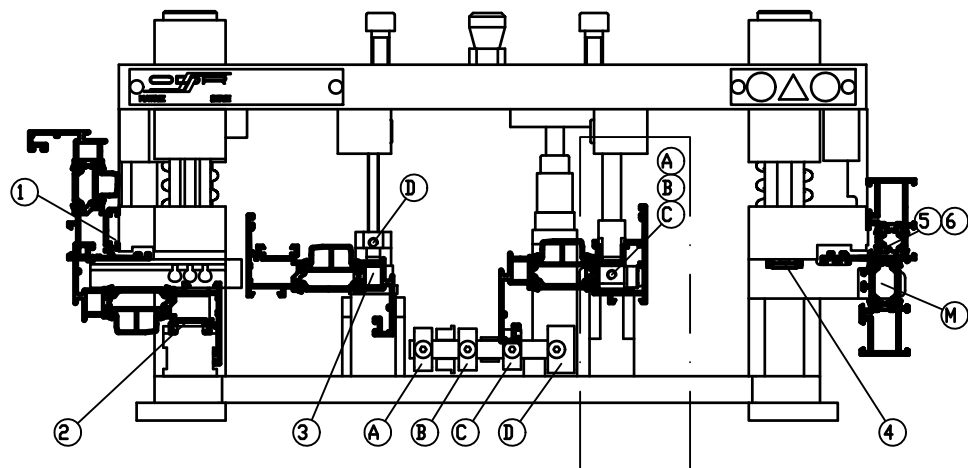

DETALLE
 ESCUADRA PRINCIPAL
 7 8 9 10 11 12

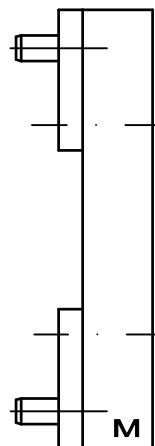
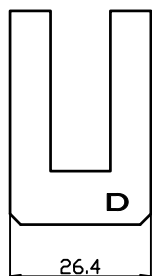

OPERACION 13:

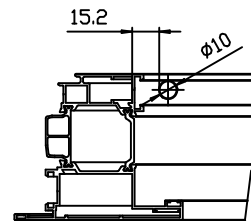

ESCUADRA Ref.: 5130 INT.
 HOJAS APERT. EXT. ALG-65/75/83
 (SIN FUNDAS)

OPERACION 15:

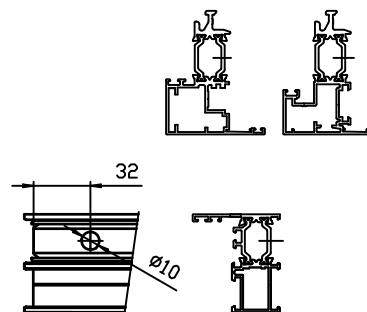

ESCUADRA Ref.: 5130 EXT.
 INTERPOLIAMIDA MARCOS ALG-55
 INTERPOLIAM. HOJAS HS 16789H y 16780H ALG-75
 (CON FUNDA F)

OPERACION 17:

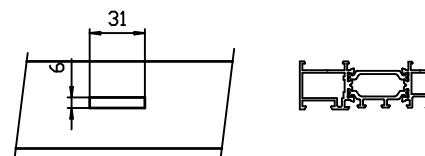

VIERTAGUAS
 MARCOS ALG-65/75/83

OPERACION 14:

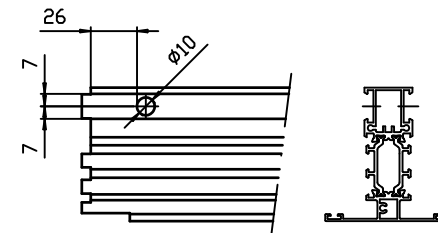

UNION
 TRAVESANOS ALG-45/55/65/75/83
 (CON FUNDA E)

OPERACION 16:

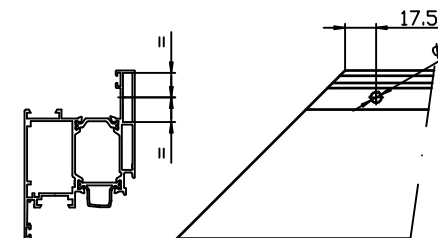

ESCUADRA Ref.: 5593
 ALA EXT. HOJAS 18467L, 18722L y 18889L ALG-55

OPERACION 18:

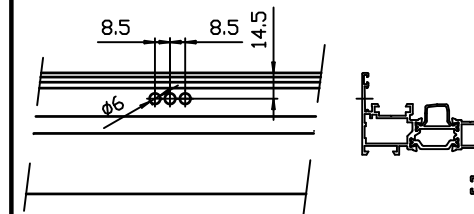

MANILLA
 HOJAS CE ALG-45/55/65/75/83

DETALLE ESCUADRA PRINCIPAL

⑦ ⑧ ⑨ ⑩ ⑪ ⑫

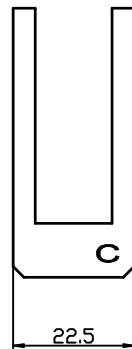
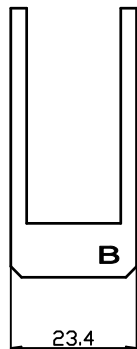
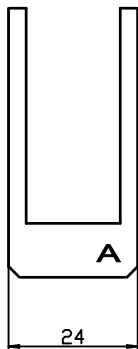
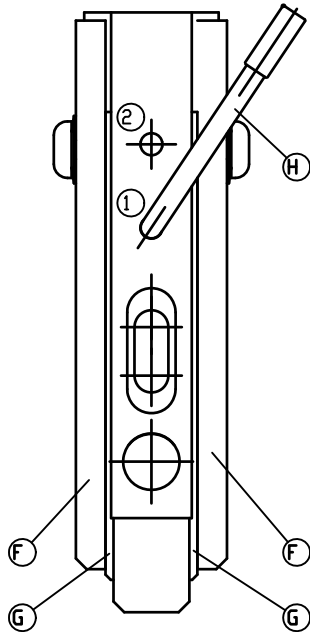

OPERACION 7:

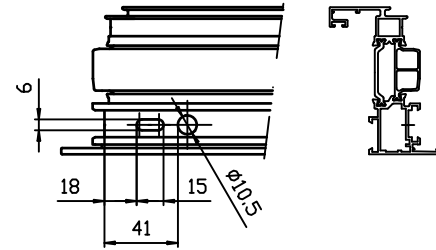

ESCUADRAS Ref.: 4847, 5104
HOJAS CE y MARCOS DE 27 ALG-45/55/65/75/83
(SIN FUNDAS) (TOPE H EN POS. 2)
(PLETINA G ARRIBA Y FIJAS)
(DESCENTRAR CON PLETINAS F ALTERNAS)

OPERACION 8:

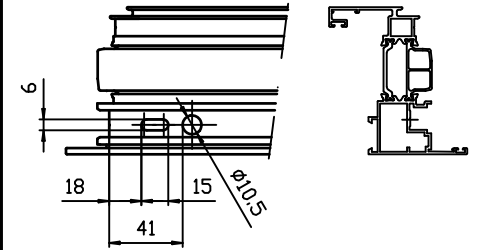

ESCUADRAS Ref.: 5134, 5135
HOJAS C-16 ALG-55/65/75/83
(SIN FUNDAS) (TOPE H EN POS. 2)
(PLETINAS G ARRIBA Y FIJAS)
(PLETINA F ABAJO)

OPERACION 9:

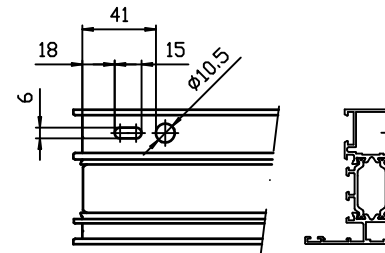

ESCUADRA Ref.: 5133
MARCOS DE 30 ALG-55/65/75/83
(CON FUNDA B) (TOPE H EN POS. 2)
(PLETINAS G ARRIBA FIJAS)
(PLETINA F ABAJO)

OPERACION 10:

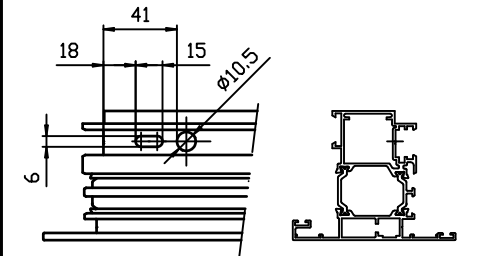

ESCUADRA Ref.: 4327
16314L Y 16316L PIVOTANTE ALG-65
(CON FUNDA A) (TOPE H EN POS. 2)
(PLETINAS G ARRIBA Y FIJAS)
(PLETINA F ABAJO)

OPERACION 11:

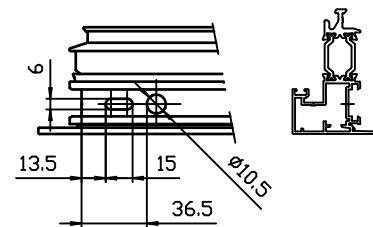

ESCUADRA Ref.: 4326
HOJAS 16765L Y 16789H CE HS ALG-65/75
(CON FUNDA C) (TOPE H EN POS. 1)
(PLETINAS F Y G ABAJO)

OPERACION 12:

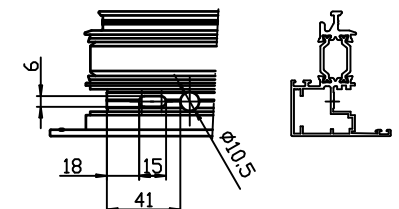

ESCUADRA Ref.: 5179
HOJAS 16780L Y 16780H C-16 HS ALG-65/75
(SIN FUNDAS) (TOPE H EN POS. 2)
(PLETINAS F y G ABAJO)

VISTA TRASERA

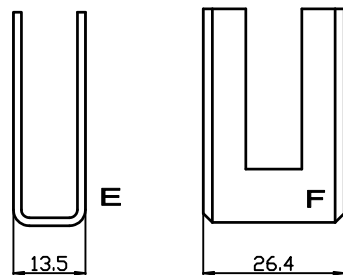
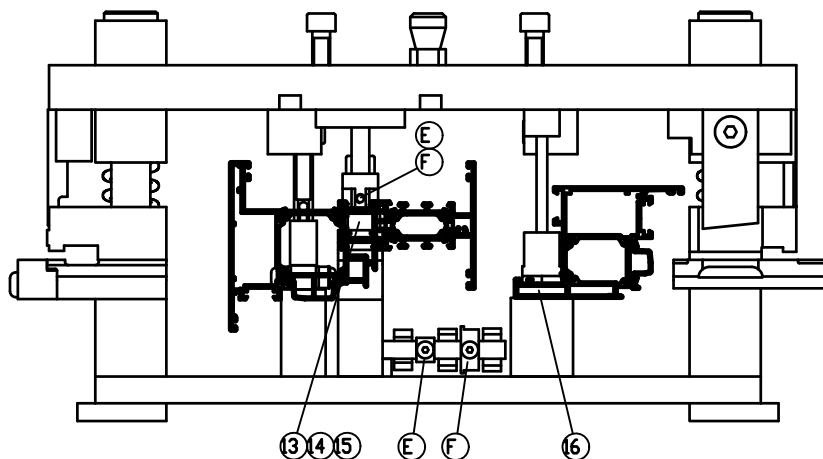

VISTA LATERAL

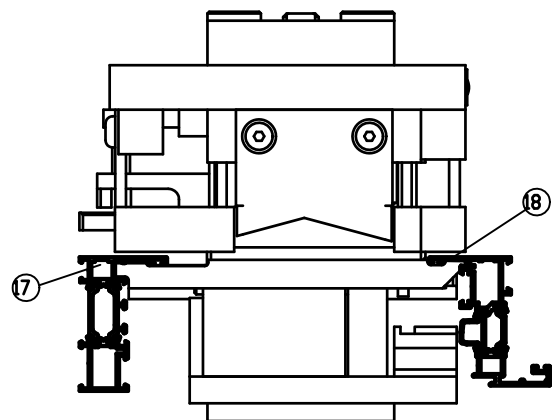

OPERACION 1:

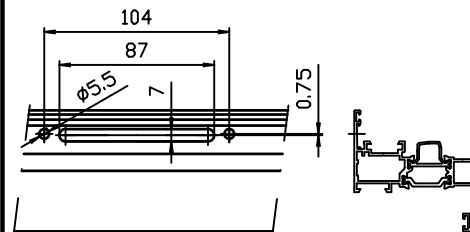

CREMONA
 HOJAS CE ALG-45/55/65/75/83

OPERACION 3:

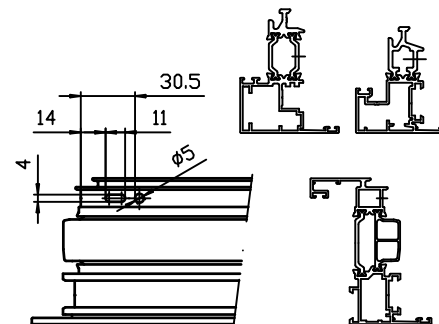

ESCUADRA EXTERIOR Ref: 1306
 HOJAS Y MARCOS ALG-65/75/83 (SIN FUNDAS)
 HOJAS HS ALG-65 16765L y 16780L (SIN FUNDAS)
 HOJAS HS ALG-75 16780H y 16789H (CON FUNDAS)

OPERACION 5:

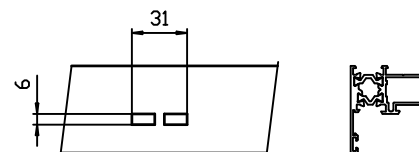

VIERTEAGUAS
 MARCOS ALG-45
 (CON SUPLEMENTO M)

OPERACION 2:

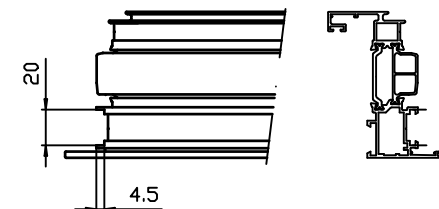

DESPUNTE NERVIOS
 HOJAS CE ALG-45/55/65/75/83

OPERACION 4:

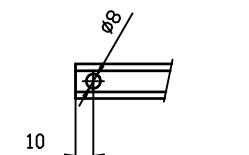

PLETINA FALLEBA
 HOJAS CE ALG-45/55/65/75/83

OPERACION 6:

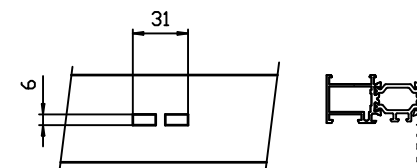

VIERTEAGUAS
 MARCOS ALG-55
 (CON SUPLEMENTO M)